

CASABOX BX2000

Cassette awning with folding arms

BX2000

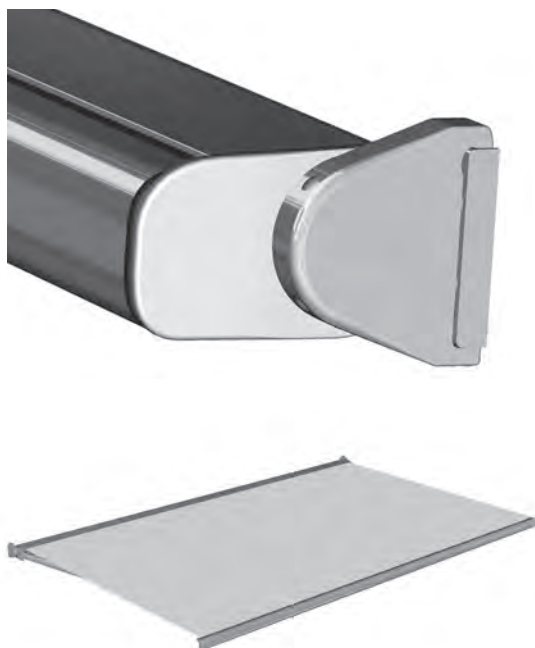

	min. 188 cm *max. 550 cm		min. 160 cm *max. 300 cm
--	-----------------------------	--	-----------------------------

	0°–80° Wall fixing 5°–90° Top fixing 5°–90° Rafter installation
--	---

* up to 500 cm total width = projection of 300 cm
as from total width of 501 cm / max. projection of 250 cm

Minimal width for a given projection

Projection	minimal width
160 cm	188
180 cm	208
200 cm	228
225 cm	258
250 cm	288
300 cm	348

Description

One-piece U-shaped protective box (152 x 123 mm) of extruded aluminium profile as support element of structure with a groove at the upper end of profile for inserting sealing brush. Side cap as cassette end for accepting roller tube $\varnothing 70$ of galvanised steel and for securing folding arms. Securing flange (on side cap) with hooks for hanging the awning on the brackets used for wall or top installation. Fixing boom, side cap, bracket are all made of aluminium casting alloy. Awning is extended and retracted manually via a bevel gearbox with integrated end stop and freewheel operating handle ring, speed reduction 4.5:1. The bevel gearbox is operated via a removable operating handle of powder-coated metal in white, grey or brown with hook and plastic handle. Front profile of extruded aluminium in rounded (58 x 107 mm) or square (62 x 107 mm) shape with matching plastic end caps. Folding arms with inverse incline of aluminium extruded profiles and precision parts of aluminium cast alloy, internal tension springs and double stainless steel cables and cable protector over the middle joint. The angle of shade is infinitely adjustable via internal hexagon bolt in securing flange from 0°–80° for wall installation, 5°–90° for top installation.

The aluminium profiles and aluminium cast parts are powder-coated in facade quality. All visible screws are stainless steel. The cover with a spin-dyed acrylic cloth (price category 1), colour fast, very high UV protection, good tensile strength, water and dirt resistant is from the STOBAG collection.

Option:

Brackets: In order to cater for different installation conditions such as poor brickwork, wood/steel structures, rafters etc., we offer a range of different types of brackets.

Wall installation profile: Aluminium extruded wall installation profile incl. side cap of aluminium sheet is attached to the facade to prevent rainwater dropping between the facade and the awning.

Electric drive:

With an electronic limit switch: Tubular AC motor 230 V, 50 Hz or 120 V, 60 Hz (according to the country) with electromechanical brakes and electronic end stop. Thermal protection, protection class IP54 (spray water), with 50–150 cm connection cable.

Remote control motor with an electronic limit switch: Tubular AC motor 230 V, 50 Hz or 120 V, 60 Hz (according to the country) with electromechanical brakes and electronic end stop. Integrated radio receiver, thermal protection, protection class IP54 (spray water), with 50–150 cm connection cable.

Cover/assembly technology: Awning covers of polyester, acrylic etc. and various assembly technologies such as gluing, TENARA stitching etc as per STOBAG collection (collection index).

METHOD OF DELIVERY

Awnings completely assembled, with cover

CASABOX BX2000

Cassette awning with folding arms

BX2000

Wall fixing

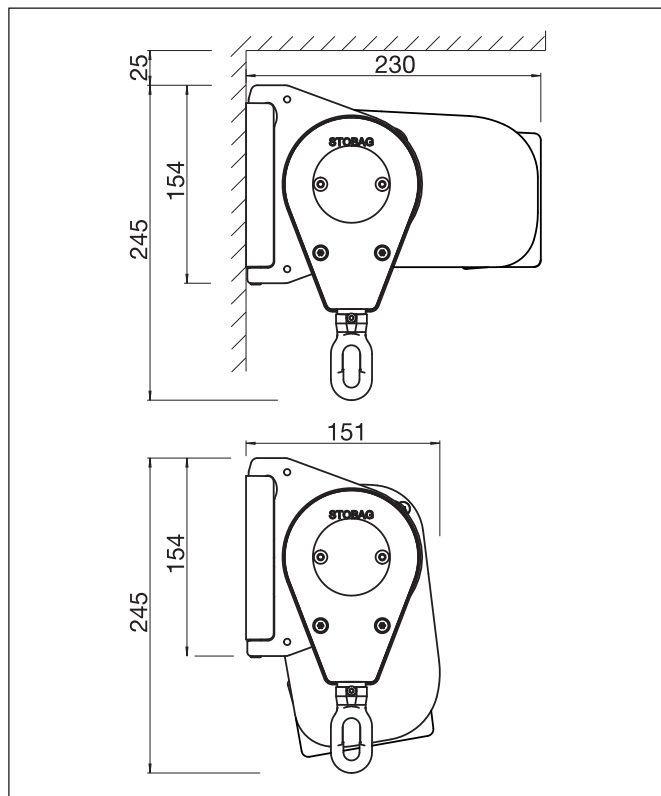
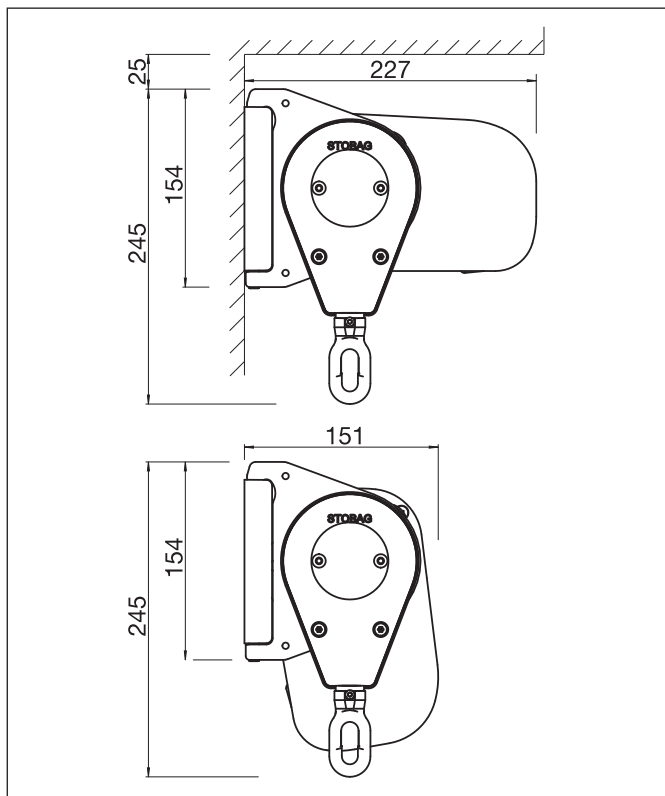

BX2000

Top fixing

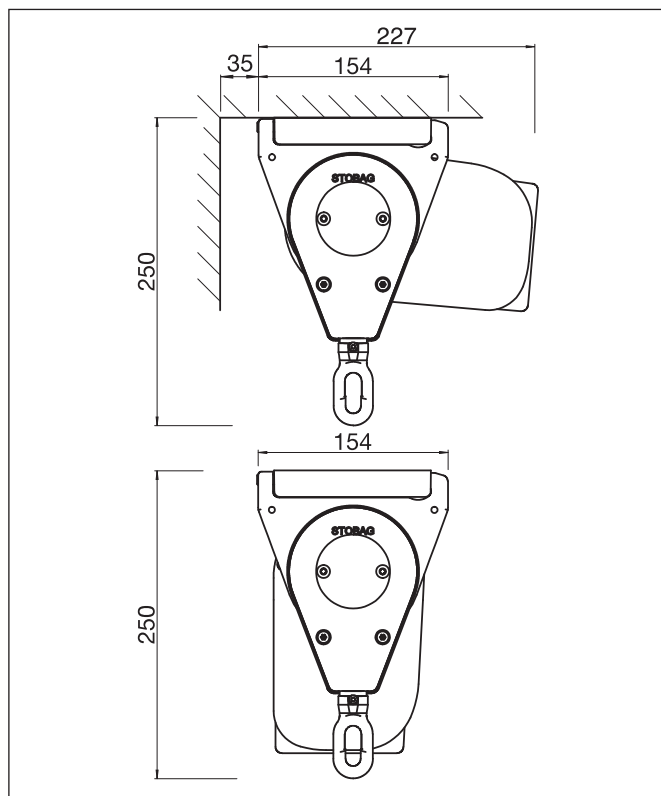
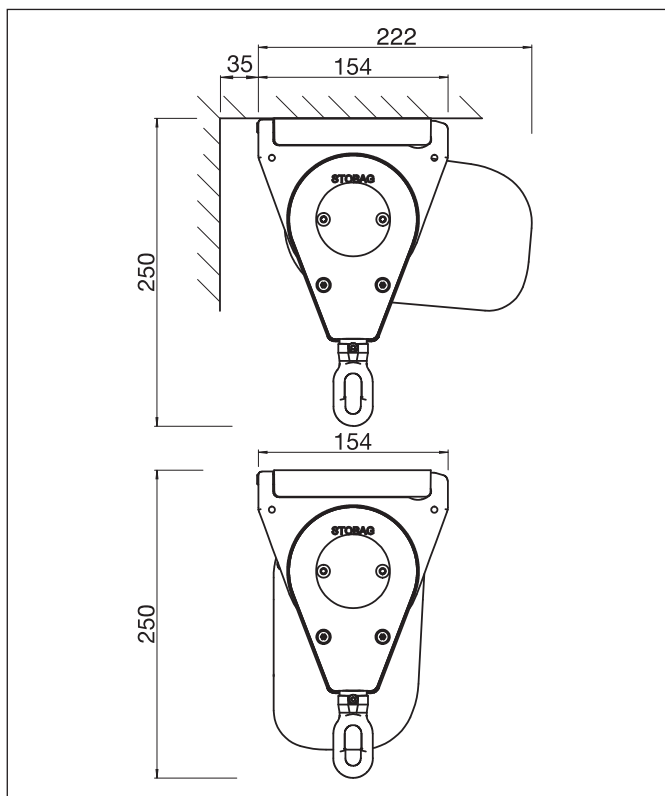

CASABOX BX2000

Cassette awning with folding arms

BX2000

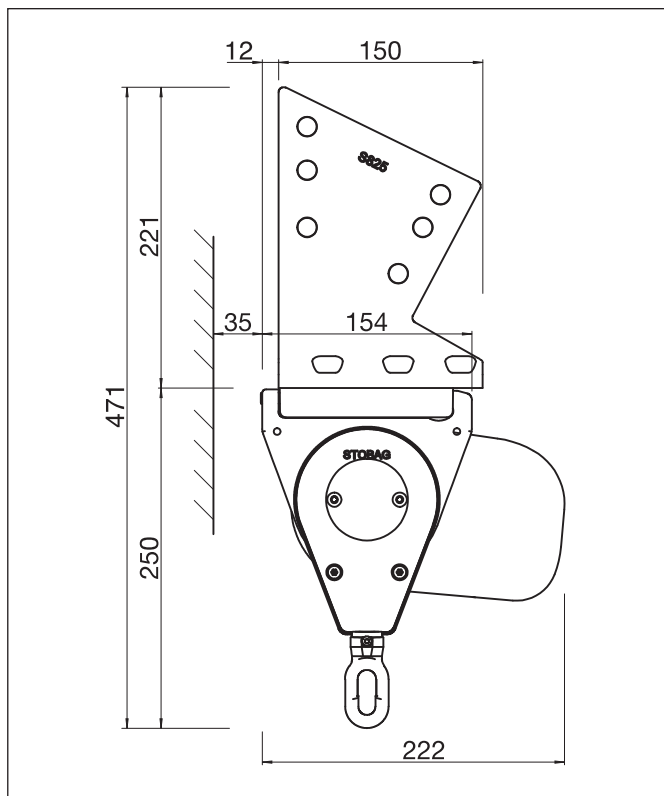

Rafter installation

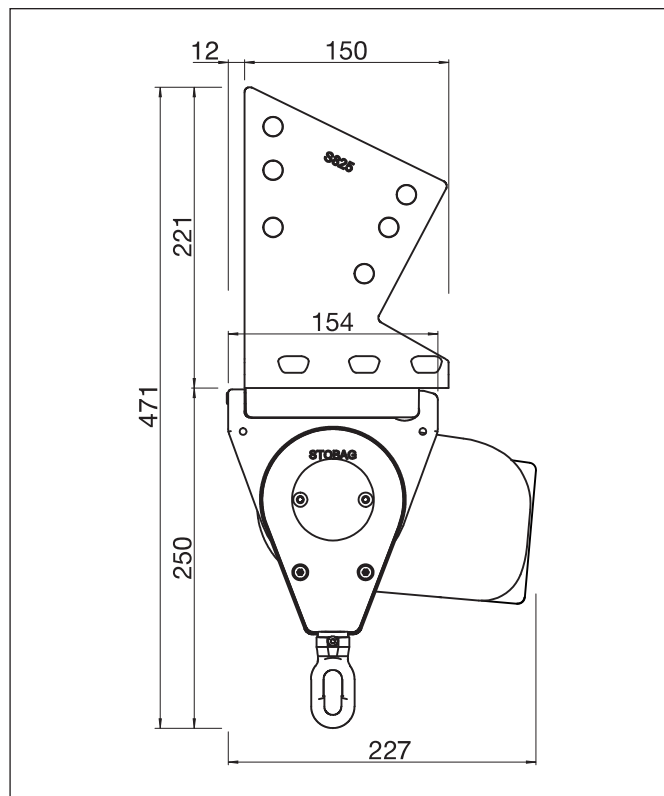

BX2000

Installation drawing

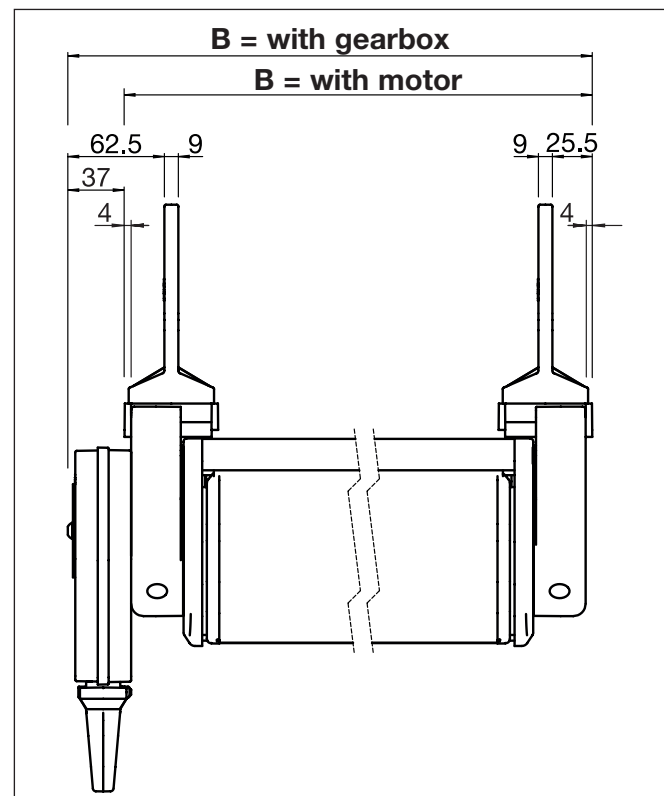
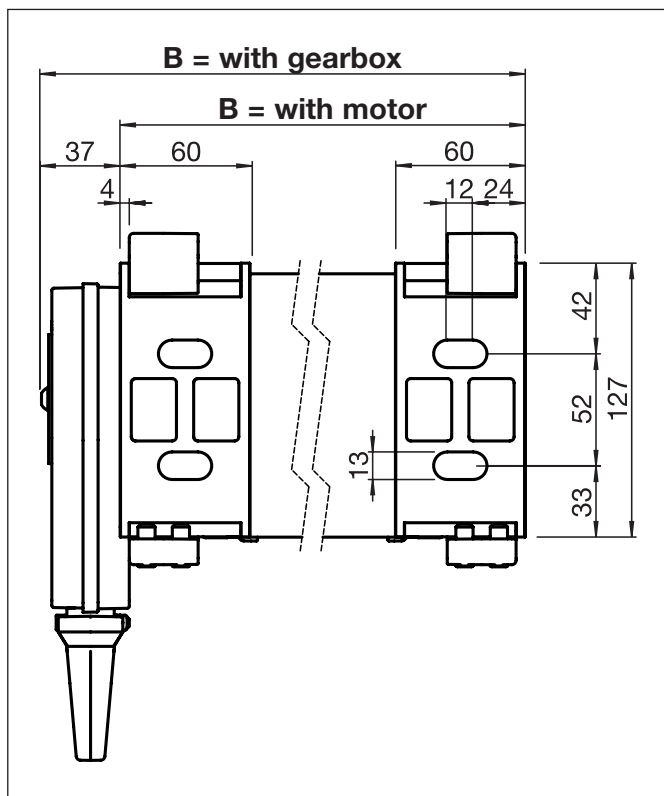

B = total width

CASABOX BX2000

Cassette awning with folding arms

BX2000

Exploded view

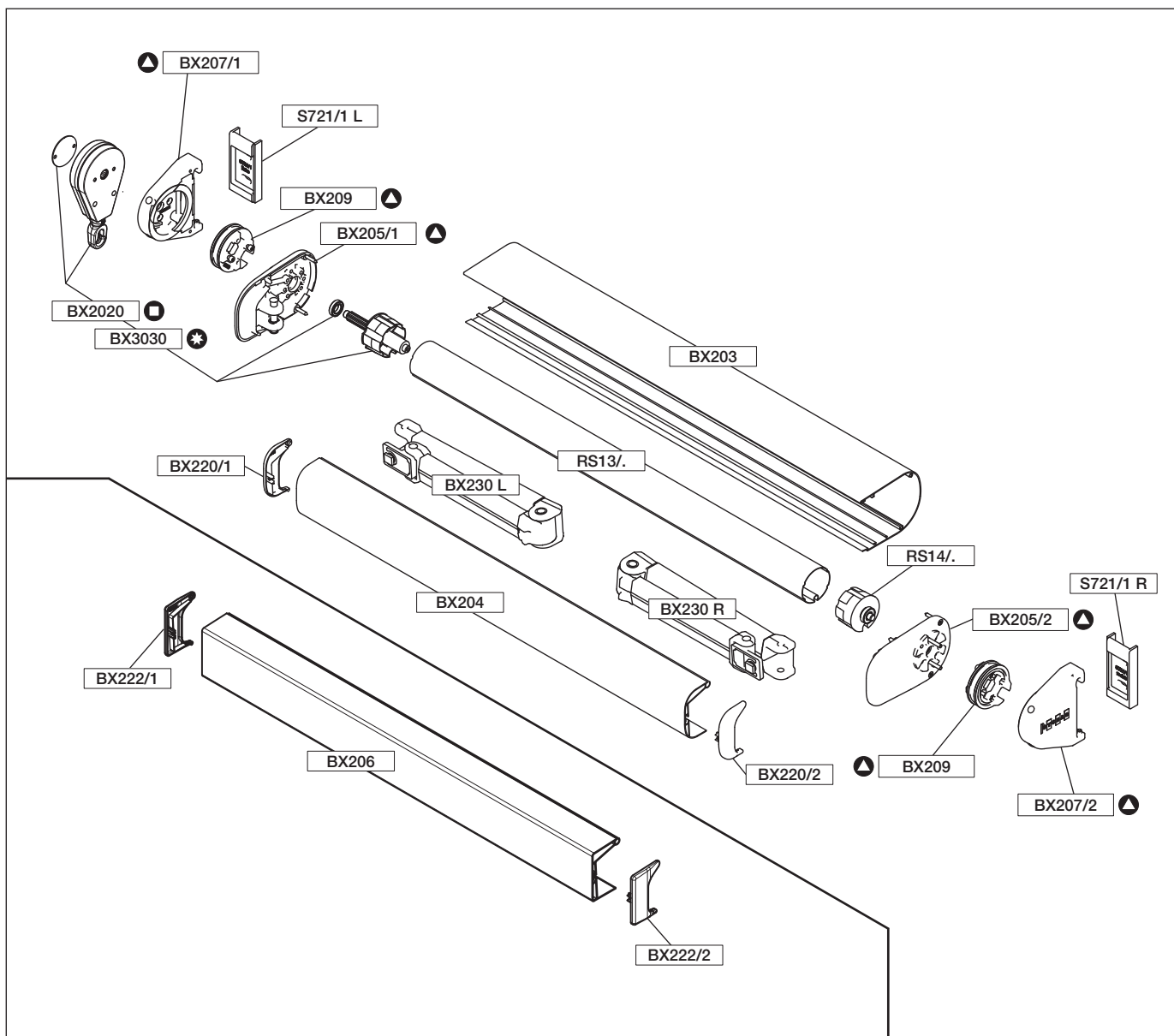

Set:

- ▲ = BX2010
- = BX2020
- ★ = BX3030

BX2000

CASABOX BX2000

Cassette awning with folding arms

BX2000

Folding arms

BX230	160 cm	pair
	180 cm	pair
	200 cm	pair
	225 cm	pair
	250 cm	pair
	300 cm	pair

Bracket

S721/1	standard	pair
S721/2	large 150 mm	pc.
S721/3	Profile 600 cm	pc.
S721/4	large 250 mm	pc.
S725	rafter	pair

Cover profile mount

S731/2 to S721/2	pc.
------------------	-----

S731/4 to S721/4	pc.
------------------	-----

Underlay profile

S842/10	1m	pc.
S842/1/40	400 cm	pc.

Cover

S846 for S842/..	pc.
------------------	-----

Tubular motors

Motor drive E / E STAS / STAK 3	pc.
Motor drive E radio / E radio STAS / STAK 4	pc.

Box profile

BX203	300 cm	pc.
	350 cm	pc.
	400 cm	pc.
	450 cm	pc.
	500 cm	pc.
	550 cm	pc.

Band brush

S510/1	grey	1m/Roll
S510/2	black	1m/Roll

Rounded front rail

BX204	300 cm	pc.
	350 cm	pc.
	400 cm	pc.
	450 cm	pc.
	500 cm	pc.
	550 cm	pc.

Rounded end caps

BX220 to BX204	pair
----------------	------

Square front rail

BX206	350 cm	pc.
	400 cm	pc.
	500 cm	pc.
	550 cm	pc.

Square end caps

BX222 to BX206	pair
----------------	------

Components list

Roller tube galvanised

RS13/3 70 x 1.00 mm	4.00 m	pc.
	4.50 m	pc.
	5.00 m	pc.
	5.50 m	pc.
	6.00 m	pc.
	7.00 m	pc.

RS13/4 78 x 1.00 mm	4.00 m	pc.
	4.50 m	pc.
	5.00 m	pc.
	5.50 m	pc.
	6.00 m	pc.
	7.00 m	pc.

Roller tube gudgeon, round

RS14/2 70 mm plastic without border	pc.
RS14/4 78 mm plastic without border	pc.

Operating handles

S804	80 cm	pc.
	100 cm	pc.
	120 cm	pc.
	135 cm	pc.
	150 cm	pc.
	160 cm	pc.
	180 cm	pc.
	200 cm	pc.

Wall connection profile

P318/1	5.00 m	pc.
	6.00 m	pc.

Side cap set

P328/1	for P318/1	pc.
--------	------------	-----

Set

BX2010	consisting of:	pc.
	1 rotary flange left BX207/1	
	1 rotary flange right BX207/2	
	2 rotary flange caps BX208	
	2 pivoting fork BX209	
	1 side cap left BX205/1	
	1 side cap right BX205/2	
	1 ball bearing	
	1 screw set	

Gearbox set

BX2020	consisting of:	pc.
	1 gear mechanism S865/7	
	1 cover plate S866	
	1 roller tube gudgeon RS19/20 70 mm	
	1 ball bearing	

Gearbox set

BX3030	consisting of:	pc.
	1 gear mechanism S865/7	
	1 cover plate S866	
	1 roller tube gudgeon RS19/10 78 mm	
	1 ball bearing	

CASABOX BX2000

Cassette awning with folding arms

BX2010

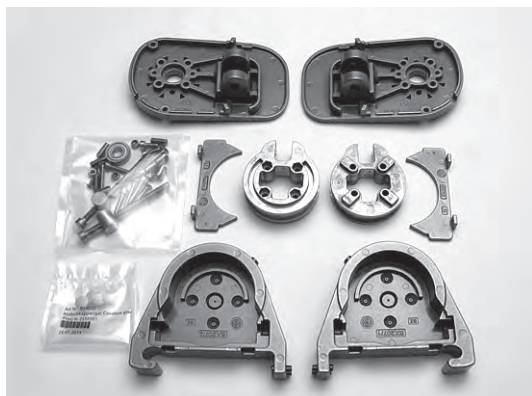

Set for CASABOX BX2000

Serves as a basic set for gear mechanisms and motor drives.

MATERIAL

Aluminium alloy casting

Set of screws: stainless steel

DELIVERY

1 rotary flange left	BX207/1
1 rotary flange right	BX207/2
2 rotary flange caps	BX208
2 pivoting fork	BX209
1 side cap left	BX205/1
1 side cap right	BX205/2
1 ball bearing	
1 screw set	

PACKAGING UNIT

Set

BX2020



Gearbox set for CASABOX (Ø 70 mm)

This drive fitting is required up to a total width of 500 cm and in conjunction with a 70 mm cover shaft.

ENGINEERING DATA

BX2020:	for drive with gearbox in connection with BX2010
Roller tube pin:	octagonal 13 x 13 Ø 70 mm

MATERIAL

Gearbox:	aluminium alloy casting
Roller tube pin:	plastic aluminium

DELIVERY

1 gear mechanism	S865/7
1 cover plate	S866
1 roller tube gudgeon	RS19/20 70 mm
1 PVC grommet	

PACKAGING

Set

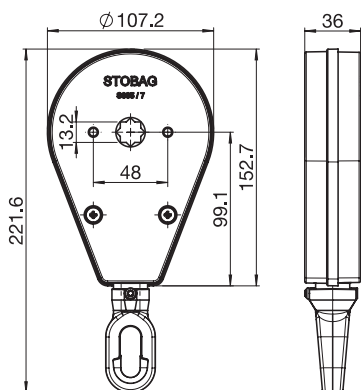

CASABOX BX2000

Cassette awning with folding arms

BX3030

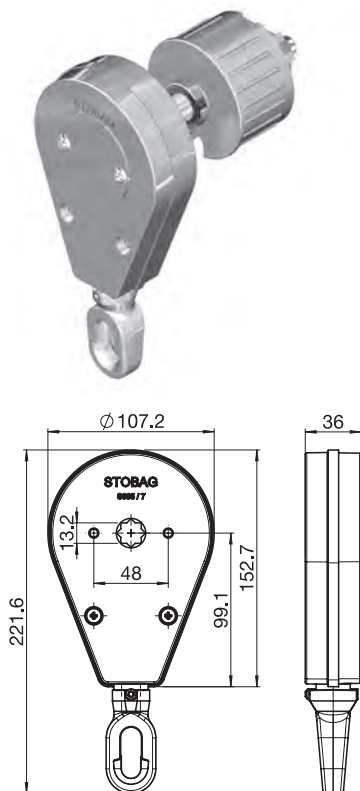

Gearbox set for CASABOX (Ø 78 mm)

This drive fitting is required as from a total width of 500 cm and in conjunction with a 78 mm cover shaft.

ENGINEERING DATA

BX3030:	for drive with gearbox in connection with BX2010
Roller tube pin:	octagonal 13 x 13 ø 78 mm

MATERIAL

Gearbox:	aluminium alloy casting
Roller tube pin:	plastic aluminium

DELIVERY

1 gear mechanism	S865/7
1 cover plate	S866
1 roller tube gudgeon	RS19/10 78 mm
1 ball bearing	

PACKAGING

Set

CASABOX BX2000

Cassette awning with folding arms

S721/1

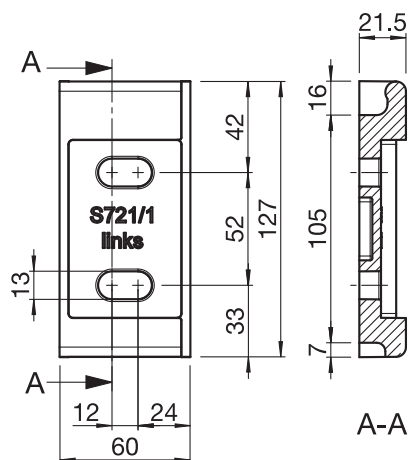

Bracket

The Casabox bracket S721/1 can be used for wall or top fixing.

ENGINEERING DATA

Use: for wall or top fixing
Application: left and right bracket necessary

MATERIAL

Bracket: aluminium alloy casting

PACKAGING UNIT

Pair

S721/2

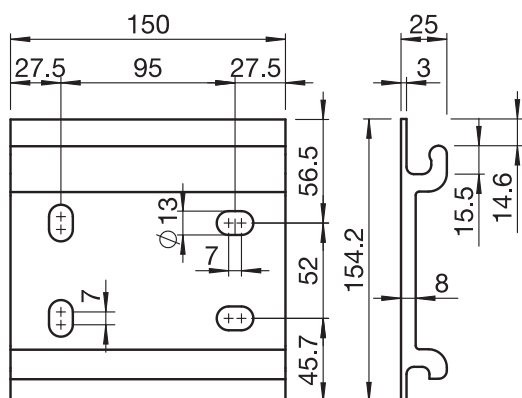

Bracket

The bracket S721/1 can be used for wall or top fixing or for side by side installations.

ENGINEERING DATA

Application: for wall or top fixing
Length: 150 mm width 4 slots 13 x 20 mm

MATERIAL

Brackets: extruded aluminium profiles

PACKAGING UNIT

Piece

S721/3

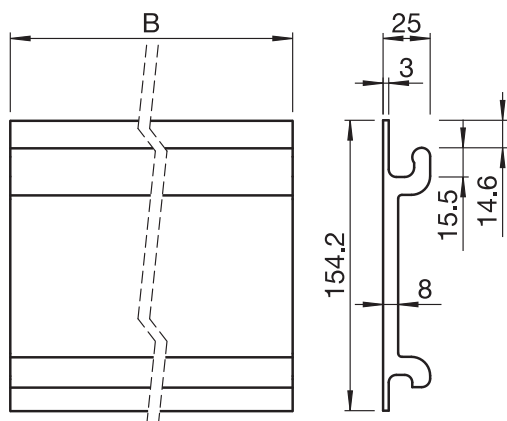

Bracket profile

The CASABOX bracket profile S721/3 is available in linear meter and can be used for wall or top fixing. Length on demand. The bracket profile has no fixation holes.

ENGINEERING DATA

Size: linear meter or 6 m profile
Application: for wall or top fix
Cut edges: not lacquered (additional charges)

MATERIAL

Extruded aluminium profile

PACKAGING UNIT

Linear meter / Piece

CASABOX BX2000

Cassette awning with folding arms

S721/4

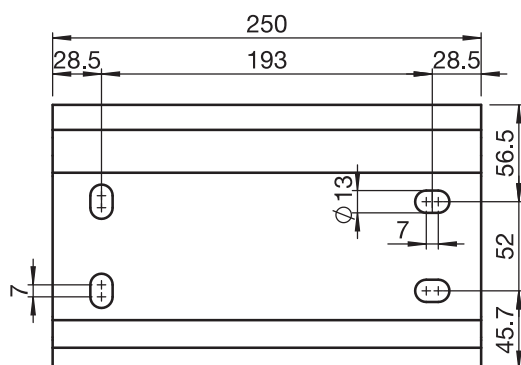

Bracket

The bracket S721/4 can be used for wall or top fixing or for side by side installations.

ENGINEERING DATA

Application: for wall or top fixing
Length: 250 mm with 4 slots 13 x 20 mm

MATERIAL

Brackets: extruded aluminium profiles

PACKAGING UNIT

Piece

S725

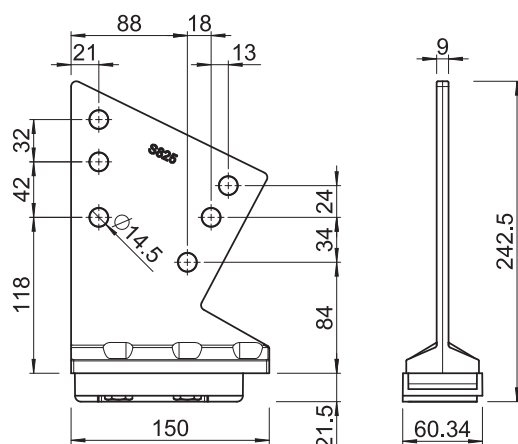

Bracket for rafters

The bracket for rafters S725 is specially made for the lateral installation on a rafter.

ENGINEERING DATA

Use: installation on rafters

MATERIAL

Bearing: aluminium alloy casting
Bracket: aluminium alloy casting

PACKAGING UNIT

Pair

S731/2

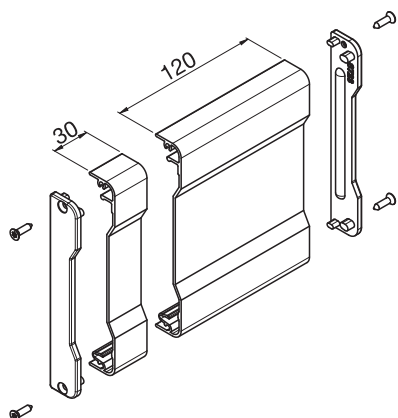

Cover profile set

The cover profile set is to be used with bracket S721/2.

ENGINEERING DATA

1 bracket cap 30 mm S722
1 bracket cap 120 mm S722
2 bracket caps – side frame S723
1 screw set

MATERIAL

Bracket cap: Aluminium extruded profile
Bracket cap side frame: Cast aluminium alloy
Screws: Stainless steel

PACKAGING UNIT

Set

CASABOX BX2000

Cassette awning with folding arms

S731/4

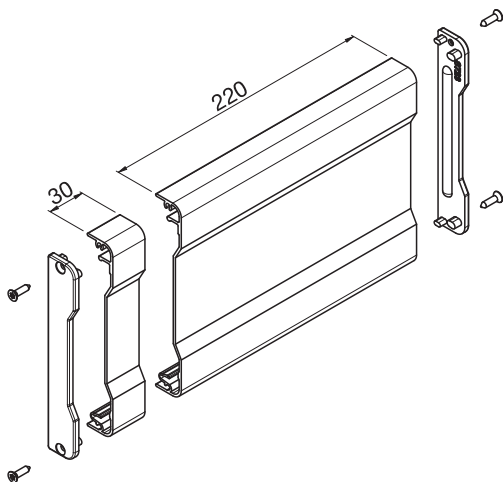

Cover profile set

The cover profile set is to be used with bracket S721/4.

ENGINEERING DATA

1 bracket cap 30 mm	S722
1 bracket cap 120 mm	S722
2 bracket caps – side frame	S723
1 screw set	

MATERIAL

Bracket cap:	Aluminium extruded profile
Bracket cap side frame:	Cast aluminium alloy
Screws:	Stainless steel

PACKAGING UNIT

Set

S842

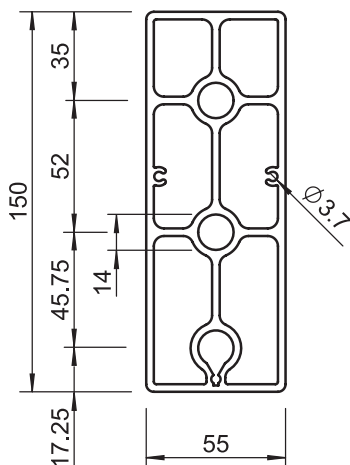

Underlay profile

Underlay profile for S721/1 fixing brackets. Suitable for exterior insulation or rafters.

ENGINEERING DATA

Standard lengths:	S842/10 = 1m
	S842/1/40 = 400 cm

MATERIAL

Extruded aluminium profiles

PACKAGING UNIT

Piece

S846

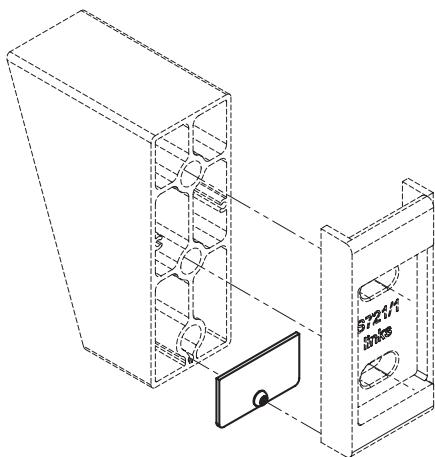

Cover

This cover is used in combination with the S721/1 fixing bracket and S842 underlay profile. This covers the gap that is created.

MATERIAL

Aluminium sheet	55 x 29.5 x 2 mm
-----------------	------------------

PACKAGING UNIT

Piece

CASABOX BX2000

Cassette awning with folding arms

BX203

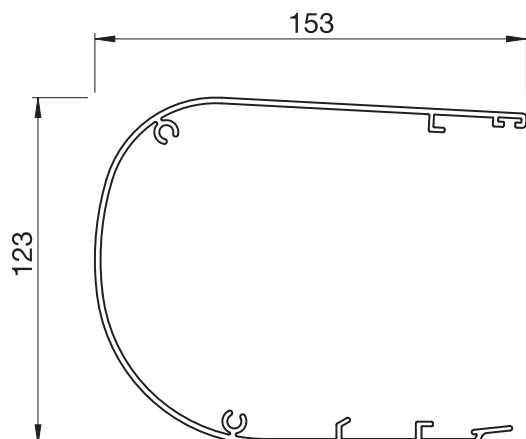

Box profile

The box has a slot to take the band brush.

The band brush is not included in the delivery package.

ENGINEERING DATA

Standard lengths: 300, 350, 400, 450, 500, 550 cm

MATERIAL

Extruded aluminium profiles

PACKAGING UNIT

Piece

S510/.

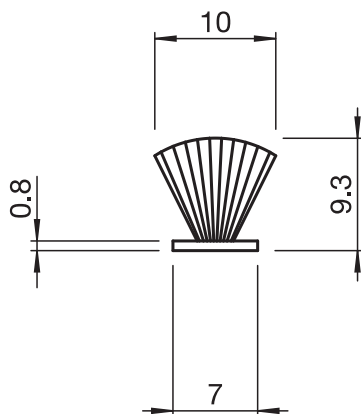

Band brush

Band brush for the box BX203.

ENGINEERING DATA

Size: S510/1 = grey
S510/2 = black

MATERIAL

Brush: plastic

PACKAGING UNIT

Rolls or linear meter

BX204

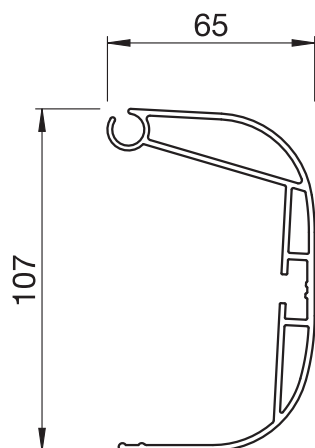

Rounded front rail

Front rail for BX203 box profile.

ENGINEERING DATA

Standard lengths: 300, 350, 400, 450, 500, 550 cm

MATERIAL

Extruded aluminium profiles

PACKAGING UNIT

Piece

CASABOX BX2000

Cassette awning with folding arms

BX220

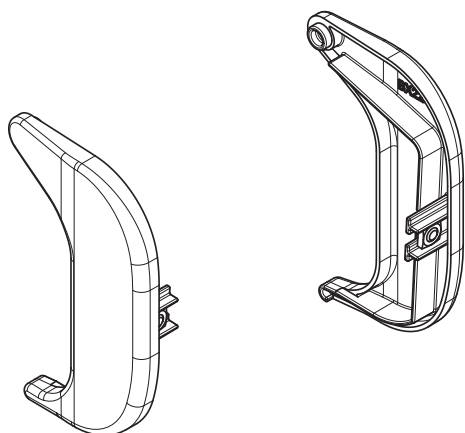

End caps

Lateral end caps for front rail BX204.

MATERIAL

Plastic:

Set of screws: stainless steel

PACKAGING UNIT

Pair

BX206

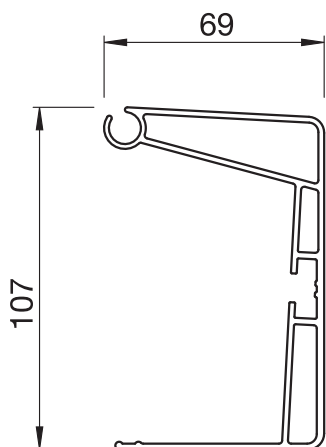

Square front rail

Front rail for BX203 fixing bracket.

ENGINEERING DATA

Standard lengths: 350, 400, 500, 550 cm

MATERIAL

Extruded aluminium profiles

PACKAGING UNIT

Piece

BX222

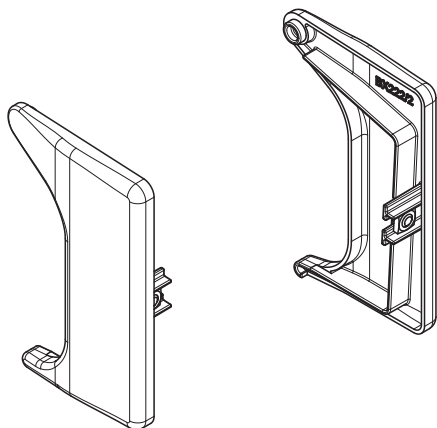

End caps

Lateral end caps for front rail BX206.

MATERIAL

Plastic:

Set of screws: stainless steel

PACKAGING UNIT

Pair

CASABOX BX2000

Cassette awning with folding arms

P318/1

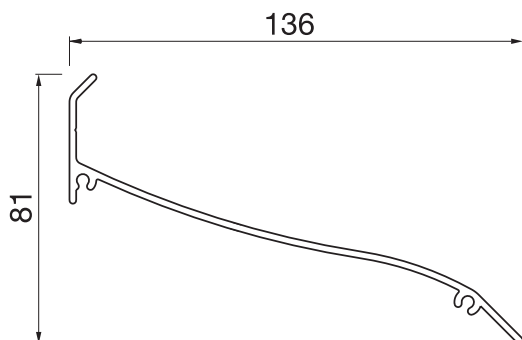

Wall connection profile

The wall connection profile is to be attached to the facade, thus preventing the rain to drop between the facade and the awning. On wall fix installations the profile must be caulked with Silicone.

MATERIAL

Extruded aluminium profile

PACKAGING UNIT

Piece

P328/1

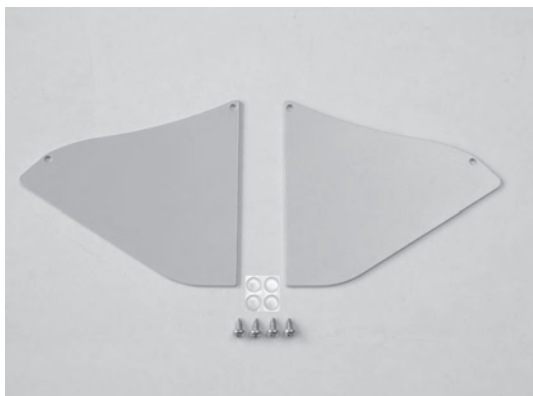

Side cap set

Side caps for wall connection profile P318/1.

MATERIAL

Side caps:	aluminium sheet
Screws:	stainless steel

PACKAGING UNIT

Set

CASABOX BX2000

Cassette awning with folding arms

BX230

Folding arms

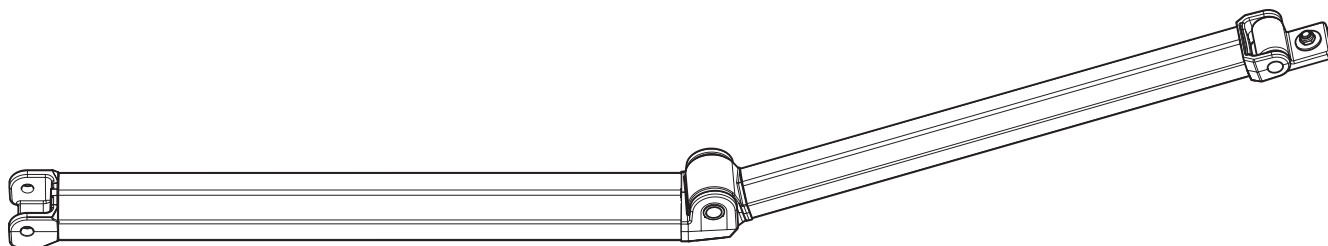

Folding arms for CASABOX box awning BX2000 up to 300 cm projection. The middle joint has a negative break.

ENGINEERING DATA

Arms with integrated springs. Arm projections are generally measured from wall to the leading edge of the front rail.

Profile sizes: 51 x 28 mm 67 x 39 mm
Standard lengths: 100, 160, 180, 200, 225, 250, 300 cm

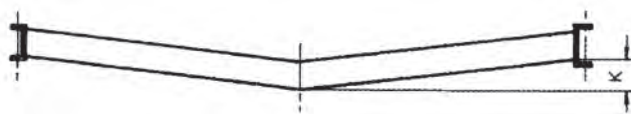

Length of arms	100 cm	160 cm	180 cm	200 cm	225 cm	250 cm	300 cm
K in cm	3	5	6	7	8	9	11

MATERIAL

Arm profiles: extruded aluminium profiles
Joints: aluminium alloy casting
Double cables: stainless steel cables with sleeves

PACKAGING UNIT

Pair or palett of 25 pairs

CASABOX BX2000

Cassette awning with folding arms

RS13/3

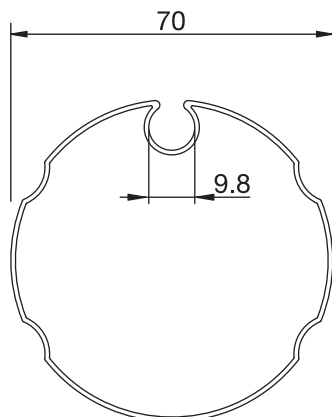

Roller tube 70 mm galvanised

Roller tube 70 mm galvanised, for all STOBAG awnings.

ENGINEERING DATA

RS13/3 $\varnothing 70 \times 1.00$ mm galvanised
Standard lengths: 400, 450, 500, 550, 600, 700 cm

MATERIAL

Steel profile galvanised

PACKAGING UNIT

Piece

RS13/4

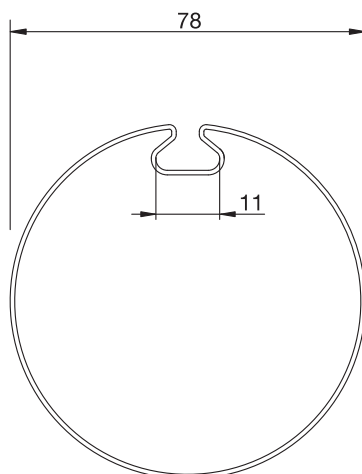

Galvanized roller tube 78 mm

Galvanized roller tube 78 mm with flat groove is suitable for all STOBAG awnings.

ENGINEERING DATA

RS13/4 $\varnothing 78 \times 1.00$ mm galvanized
Standard lengths: 400, 450, 500, 550, 600, 700 cm

MATERIAL

Steel sheet galvanized

PACKAGING UNIT

Piece

RS14/.



Roller tube gudgeon round (plastic without border)

Bearing pin standard without edge, suitable for roller shaft RS13/..

ENGINEERING DATA

RS14/3 for 70er Galvanized roller
RS14/4 for 78er Galvanized roller

MATERIAL

Roller tube gudgeon: Plastic

PACKAGING UNIT

Piece