



SIRO



BALCONY & TERRACE

**CAN BE USED FOR LATERAL SHADE
AS WELL AS FOR PROTECTION AGAINST
WIND AND PRYING EYES**

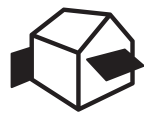

SIRO SR5000 | SR6000 FLEX



SR5000 Wall fixing



SR6000 Suspension system



Wall installation

SR5000 | SR6000 FLEX

- Can be used for lateral shade as well as for protection against wind or prying eyes
- Integrated spring shaft ensures high cover tensioning
- Various installation options such as wall brackets, floor sleeves or supports
- Swivel mounting flange allows awning to be rolled up in any direction (SR5000)
- Hanging box system for many applications (SR6000)

Box width

	min.	120 cm
	max.	200 cm

Pull out lenght

	min.	100 cm
	max.	400 cm



max. 50 km/h



Technical dimensions in millimetres

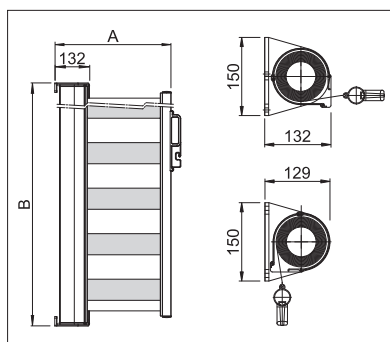

SR5000 Wall fixing

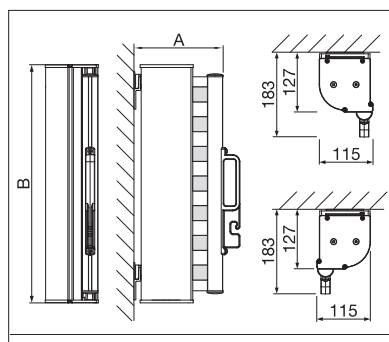

SR6000 Wall fixing / Top fixing

REGISTRATION
REQUIRED

COLOURS

Discover the diverse options
when selecting frame colours.



FABRICS

Choose from a comprehensive
range of materials and colours.

More information at www.stobag.com

STOBAG