



CONSERVATORY & ATRIUM

**CANOPY HAS FLEXIBLE APPLICATIONS WITH
FABRIC OR LAMELLAS**



ASTANO TR4110 SOFTTOP-LIGHT | TR4120 SOFT- TOP | TR4520 HARDTOP



TR4520 Soffit fixing

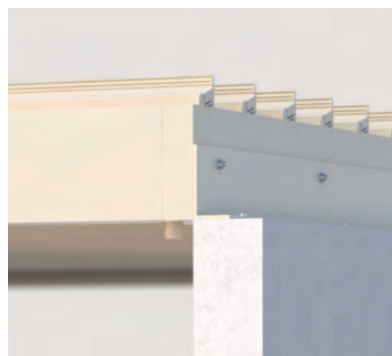

Fixed-point mounting

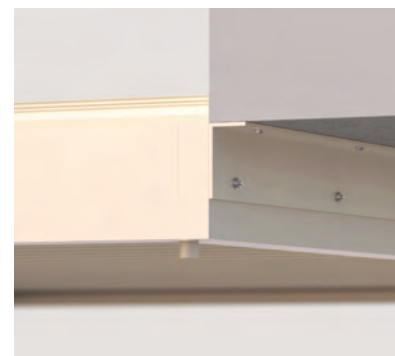

Suspended installation

- Combined solution for sun and rain protection
- Use as a rain protection system at a 0° angle
- Modular system with two roof variants: Inclining aluminium lamellas (Hardtop), stable folding awning (Softtop-Light, Softtop)
- Corrosion-resistant aluminium construction in a cubic design
- Wide assembly range: Mounted, soffit or ceiling installation possible
- As standard with electric drive
- Integrated water run-off (TR4120/TR4520)
- Optional, dimming LED lighting (TR4120/TR4520)

TR4110 Softtop-Light

	min.	200 cm
	max.	500 cm
	min.	200 cm
	max.	700 cm



TR4120 Softtop* TR4520 Hardtop

	min.	200 cm
	max.	500*/600 cm
	min.	200 cm
	max.	600 cm

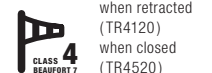

Technical dimensions in millimetres

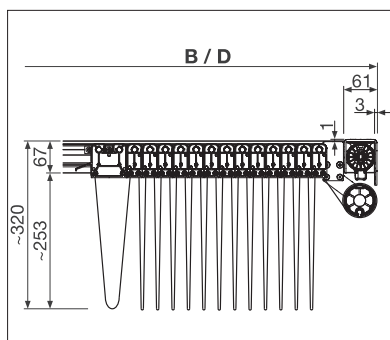

TR4110 Side view of fabric track

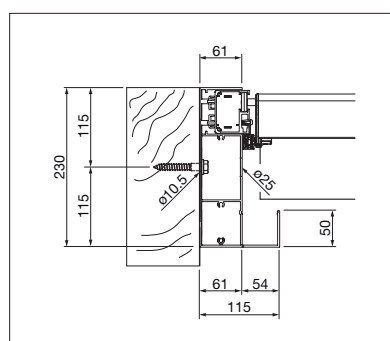
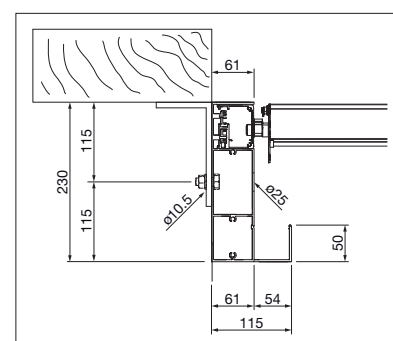
TR4120 Beam profile intersection
(Soffit mounting)TR4520 Beam profile intersection
(Top installation)

EN 13561

REGISTRATION
REQUIRED

COLOURS

Discover the diverse options when selecting frame colours.



FABRICS

Choose from a comprehensive range of materials and colours.



ELECTRICS

More convenience thanks to the automated control and lighting systems.